

# Installation Instruction

## Model: 0101-0316

- STEP 1. Remove all contents from the received box and check stainless steel tube for any dent. Also verify all brackets and bolts against the parts list.
- STEP 2. Read installation manual and installation drawing completely. Understand all brackets and bolts before installation.
- STEP 3. Install mount brackets to truck body using M8 hex head bolt, M8 flat and lock washer as shown.
- STEP 4. Fasten mount brace one end to truck body and other end to mount bracket using M8 hex head bolt, M8 flat washer and M8 lock washers as shown.
- STEP 5. Fasten step bars to mount bracket using M10 button head cap screws and M10 internal tooth lock washers as shown. Torque M10 bolts to 30 ft-lbs and M8 bolts to 25 ft-lbs.

0101-0316			
Item No	Part Number	Part Description	QTY
1	0101-0316-01	STEP BAR - DRIVER SIDE	1
2	0101-0316-02	STEP BAR - PASSENGER SIDE	1
3	0101-0316-03	MOUNT BRACKET	4
4	0101-0316-04	MOUNT BRACE	4
6	0101-0316-11	M8-1.25H EX HEAD BOLT	16
7	0101-0316-12	M8 LOCK WASHER	16
8	0101-0316-13	M8 FLAT WASHER	20
9	0101-0316-14	M8 X 1.25 HEX NUT	4
10	0101-0316-15	M10-16 BUTTOM HEAD CAP SCREW	8
11	0101-0316-16	M10 INTERNAL TOOTH LOCK WASHER	8
TOOLS REQUIRED			
13MM SOCKET / WRENCH			
7/32" HEX ALLEN WRENCH			
RATCHET			
TORQUE WRENCH			

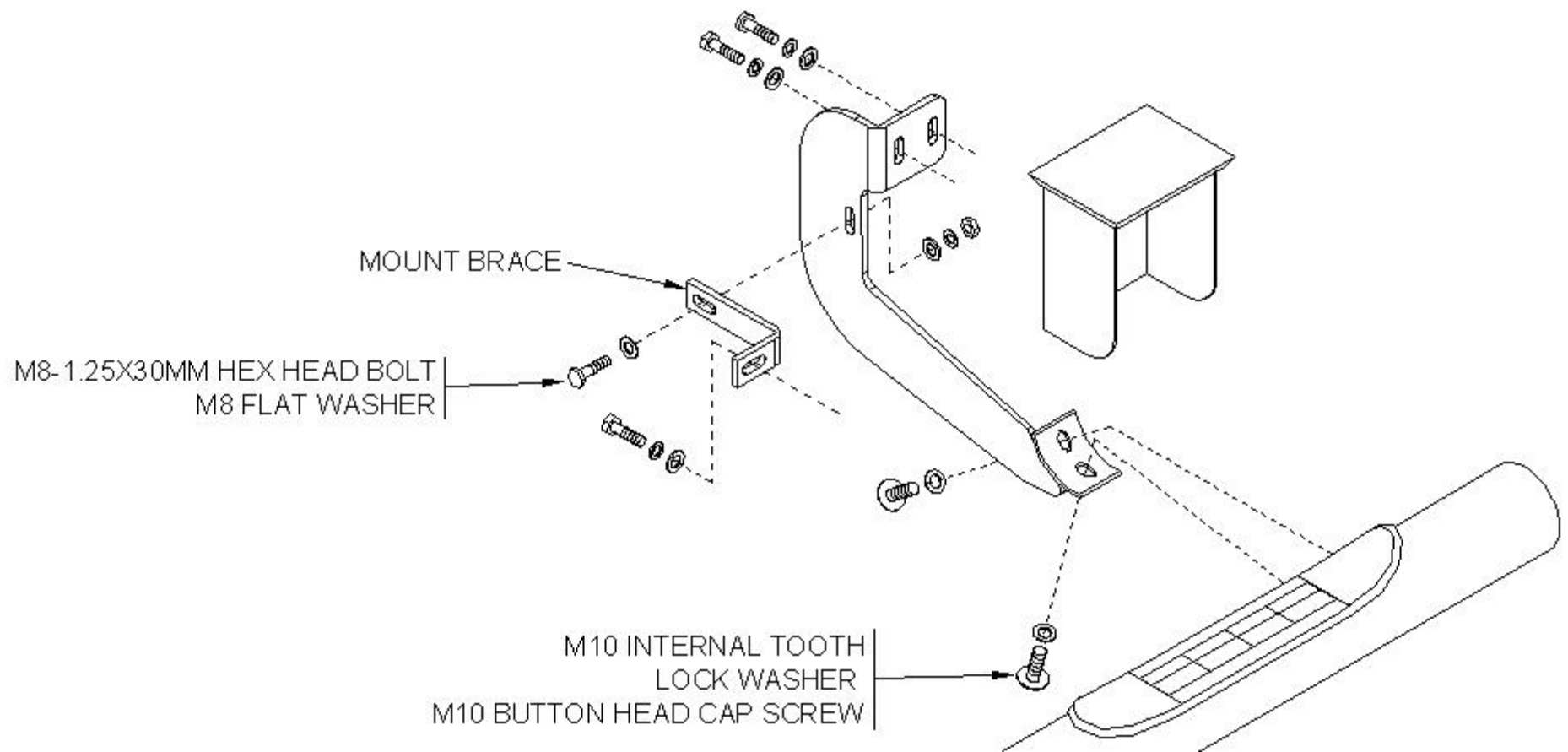

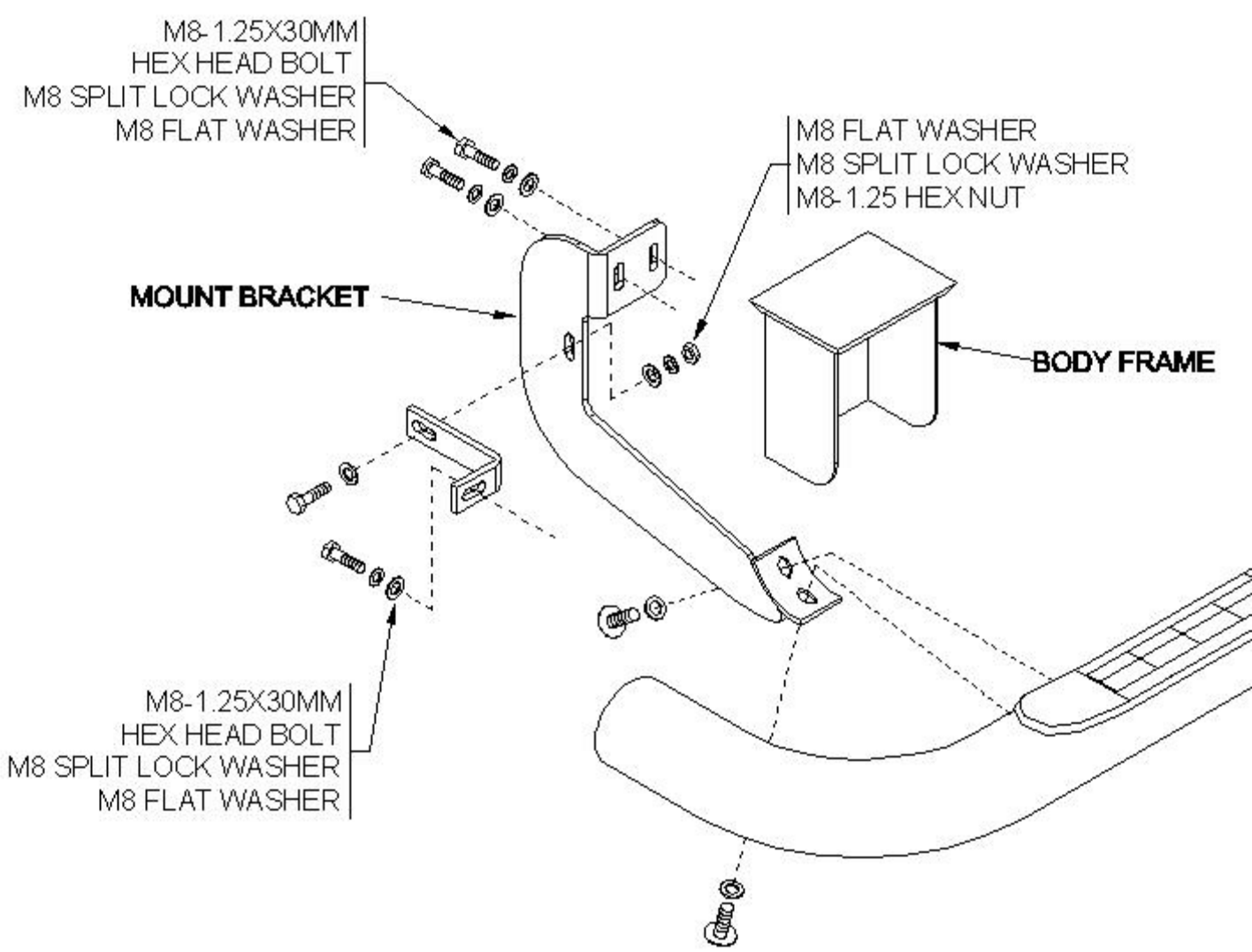

# 0101-0316

## DRIVER SIDE INSTALLATION SHOW

