

INSTALLATION NOTES

PROFESSIONAL INSTALLATION IS STRONGLY RECOMMENDED!

If you intend to do this installation yourself, please use extreme caution when working under a vehicle that is supported with jack stands. Serious injury or death can occur.

Read through entire installation manual to ensure that you understand all of the steps before proceeding with installation. If these instructions are not properly followed, severe frame, suspension, and tire damage may occur. Product failure or vehicle damage caused by improper installation will not be covered under warranty!

Remove all contents from the package and inspect for any damage. Also, verify that all components listed are included before you begin installation. If anything is missing or damaged please contact us at customerservice@cyc-engineering.com - IMPORTANT: DO NOT INSTALL DAMAGED PARTS!

COMPONENTS

Qty 1: HD Adjustable Rear Track Bar

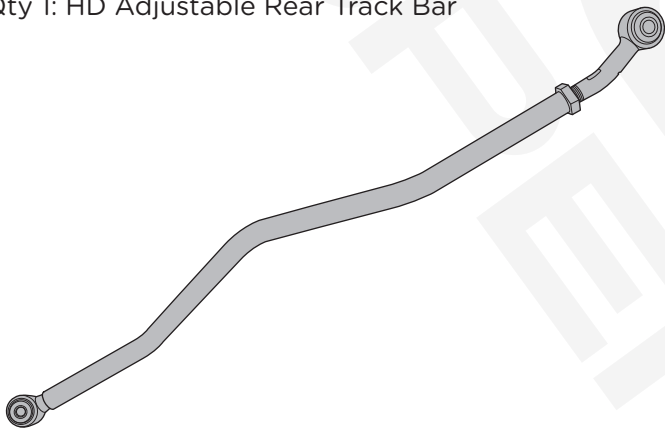

TOOLS REQUIRED

- 21mm Socket/Wrench
- 1 13/16" Open-End Wrench
- 21mm Open-End Wrench
- Torque Wrench
- Tape Measure
- Heavy Duty Ratchet Strap
- Anti-Seize Lubricant
- Factory Service Manual

REMOVE REAR TRACK BAR

1. Using a 21MM Socket/Wrench, remove the bolt connecting the rear track bar to the axle mount.
2. Using a 21MM Socket/Wrench and a 21MM Open-End Wrench, remove the bolt connecting the rear track bar to the vehicle chassis.
3. Save original hardware to be used for installation.
4. Once both bolts have been removed, you may remove the original track bar from the vehicle.

CENTER REAR AXLE

Determine if the axle housing is centered with the chassis by measuring the distance between the tires and chassis, using the same points on each side of the vehicle to ensure accuracy.

If the two measurements are the same, the axle is centered. If the two measurements are different, divide the difference in half to determine the amount of required adjustment. The chassis can be shifted using the following method.

Ratchet Strap Method

1. Attach a heavy duty ratchet strap to the chassis on one side of the vehicle and to the axle housing on the other side.
2. Tighten the strap in small increments to pull the chassis in alignment with the axle.
3. Take measurements after each adjustment until centered.

INSTALL REAR TRACK BAR

1. Apply anti-seize lubricant to bolt threads of original track bar mounting hardware as well as the adjustment threads of the track bar.

2. With the axle centered beneath the chassis, loosely attach the track bar to the chassis side using factory hardware. (a)

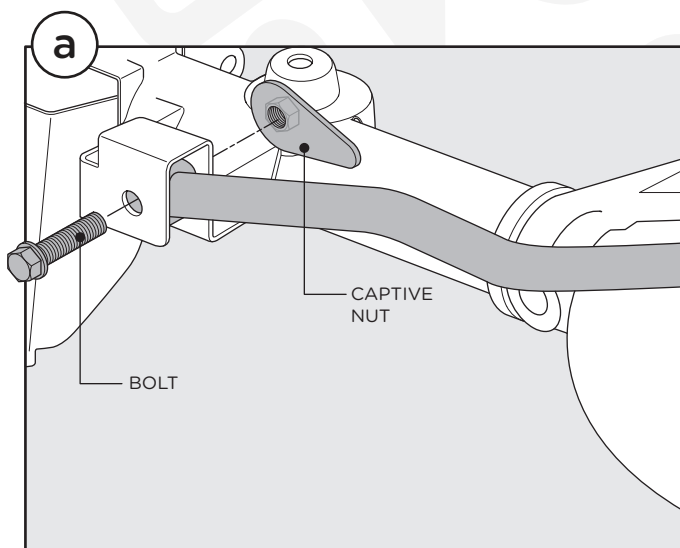

3. Loosen jam nut on the rear track bar and turn the adjusting shaft until the sleeve in the rubber bushing aligns with the mount hole on the chassis mount.

4. Loosely attach the track bar to the chassis mount using factory hardware. The bend in the adjusting shaft must point down to prevent interference during suspension articulation. (b)

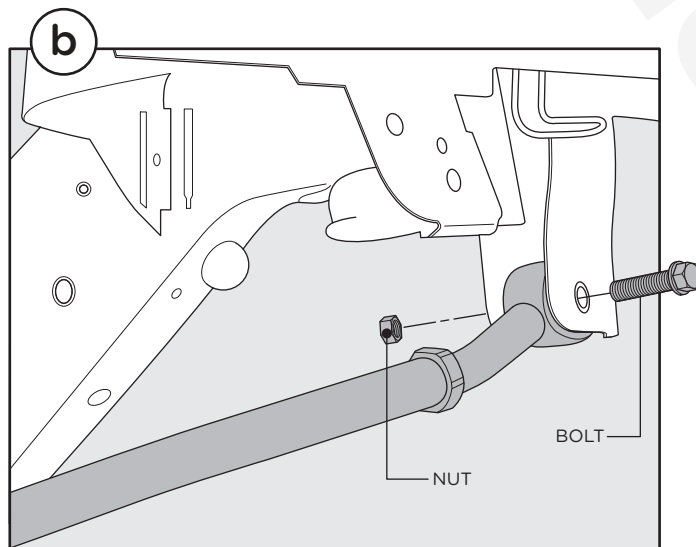

Take measurements again to ensure the axle is perfectly centered beneath the chassis and make any final adjustments if necessary.

Once all adjustments have been completed, tighten the jam nut using a 1 13/16" Open-End wrench. It may be easier to tighten the jam nut with the track bar removed from the vehicle.

Using a torque wrench, tighten the factory track bar bolts at both ends of the track bar to 125 ft-lbs.

Upon completion of installation and within 50 miles of driving, it is necessary to check and ensure all hardware is properly torqued to factory specifications as noted in the factory service manual or as specified in this instruction.