

# 18-UP JEEP JL 0-4.5" LIFT ADJUSTABLE FRONT LOWER CONTROL ARM KIT (DRIVER & PASSENGER)

**raptorseries**  
OFFROAD & PERFORMANCE

---

## Components:



Front Lower Control Arm  
Driver Side  
Qty 1

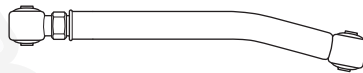

Front Lower Control Arm  
Passenger Side  
Qty 1

---

## Tools Required:

- Hydraulic Jack/Jack Stands
- Torque Wrench
- Tape Measure
- Anti-Seize Lubricant
- 21 MM Socket/Wrench
- 21 MM Open-End Wrench
- Angle Finder

---

## Safety Warning:

Aftermarket suspension systems or components may cause your vehicle to handle differently than it would with factory components. Please use caution to prevent loss of control or vehicle rollover during quick sharp turns and other sudden maneuvers. Thoroughly inspect vehicle suspension and components before and after every off-road use.

Raptor Series Off-Road recommends the use of your Factory Service Manual for disassembly and assembly of factory and related components. Tighten all bolts and hardware to factory torque specifications unless otherwise specified in this instruction.

---

## INSTRUCTIONS:

### 1. Remove Original Lower Control Arms

Begin by raising and supporting the vehicle using a hydraulic jack and jack stands.

Raise the front axle housing back into normal ride height position ensuring that the axle housing is supported evenly. Attempting to remove or install control arms with the axle drooped or the suspension extended will cause tension on control arm hardware.

Remove the brake line control arm bracket from the original control arm. This will be reattached.

Remove the bolts and nuts attaching the control arm to the axle housing as well as the vehicle frame using a 21MM Socket/Wrench and 21MM Open-End Wrench. Retain this hardware to be used for installation.

Once these bolts have been removed, you may remove the original control arm from the vehicle. Complete installation of one side before continuing to the other.

## 2. Set Control Arm Length

Do to many variances in vehicle manufacturing and individual suspension components, we do not offer predetermined arm lengths. To make adjustments, spin the joint to increase or decrease the control arm length.

To determine the appropriate arm length for your application, you will need to take the following factors into consideration. Note that factory arm length is 24".

- Steering Clearance
- Tire Clearance
- Pinion Angle/ Caster
- Axle Position

## 3. Install Adjustable Control Arms

The Adjustable Front Lower Control Arms should be positioned to where the bend in the arm goes towards the inside of the vehicle. The fixed end will mount to the axle while the adjustable end will be attached to the frame mount.

Apply anti-seize lubricant to bolt threads of original mounting hardware.

Hand tighten the original hardware to mount each end of the control arms (3a). Once both control arms have been properly installed, lower the vehicle to the ground until the coil springs are supporting the full weight of the vehicle.

Using a torque wrench, tighten all mounting hardware to 200 ft-lbs. Tighten Jam nuts using Crescent wrench or equivalent (3b).

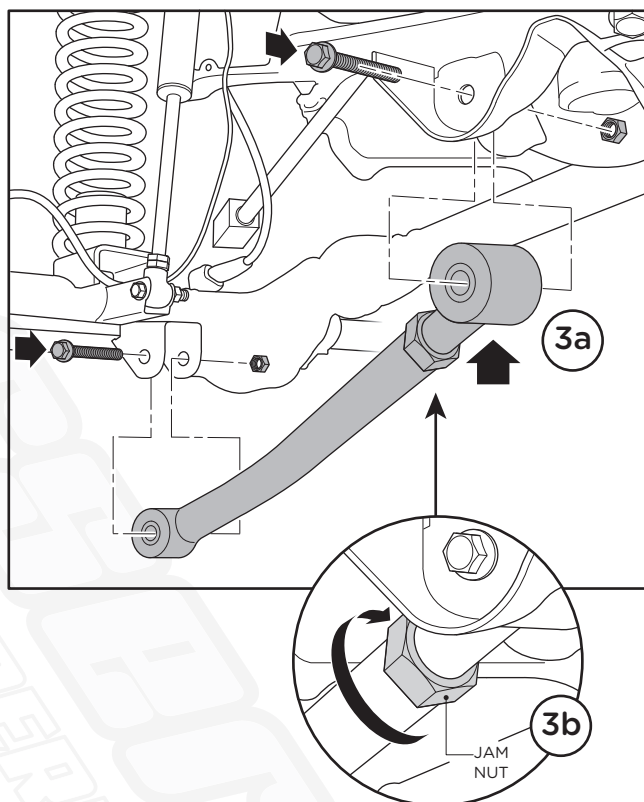

## 4. Post Installation

Installing longer lower control arms will affect the vehicle alignment by adding more caster. This could also affect the steering wheel position, causing it to be off-center. Be sure that the steering wheel is centered to avoid problems with the vehicles electronic stability control system. It is necessary to have a professional wheel alignment performed by a certified technician to ensure the vehicle is aligned to factory specifications. Upon completion of installation and within 500 miles of driving, it is necessary to check and ensure all hardware is properly torqued to factory specifications as noted in the factory service manual or as specified in this instruction.